

Plant Schedule

Qty.	Key	Botanical name	Common name	Size	Notes
EVERGREEN SHRUBS					
25	BCB	Buxus 'Glencoe'	Chicagoand Green Boxwood	24" ht.	B&B
18	TAT	Taxus media 'tauntonii'	Taunton Yew	24" ht.	B&B
PERENNIALS					
48	AAF	Astilbe arendsii 'Fanal'	Fanal Astilbe	#1 Container	18" o.c.
15	AMD	Astilbe chinensis 'Maggie Daley'	Maggie Daley Astilbe	#1 Container	18" o.c.
60	LJR	Ligularia 'Little Rocket'	Dwarf Ligularia	#1 Container	24" o.c.
161	EPP	Echinacea purpurea 'Pixie Meadowbrite'	Pixie Meadowbrite Coneflower	#1 Container	18" o.c.
120	LSF	Liatris spicata 'Floristan White'	White Gayfeather	#1 Container	15" o.c. Mix w/ LSK
240	LSK	Liatris spicata 'Kobold'	Kobold Gayfeather	#1 Container	15" o.c. Mix w/ LSF
ORNAMENTAL GRASSES AND SEDGES					
60	CAA	Calamagrostis acutiflora 'Karl Foerster'	Karl Foerster Feather Reed Grass	#1 Container	24" o.c.
238	SHT	Sporobolus heterolepis 'Tara'	Dwarf Prairie Dropseed	#1 Container	18" o.c.
GROUNDCOVERS					
1655	PAT	Pachysandra terminalis 'Green Carpet'	Japanese Spurge	#1 Container	12" o.c.

Notes:
A. All sod quantities shall be determined by the Contractor.
B. In the event of discrepancy in plant quantities between plan and Plant Schedule, larger quantity shall be provided and installed.
C. All plant materials shall be specimen quality. Trees shall be matched specimens from same nursery block.
D. All plant materials shall be B&B unless otherwise noted. Bare root plant materials will not be accepted.
E. Shrubs on a single stem shall not be accepted. All shrubs shall be multi-stem, heavily branched and symmetrically shaped.

LEGEND AND ABBREVIATIONS:

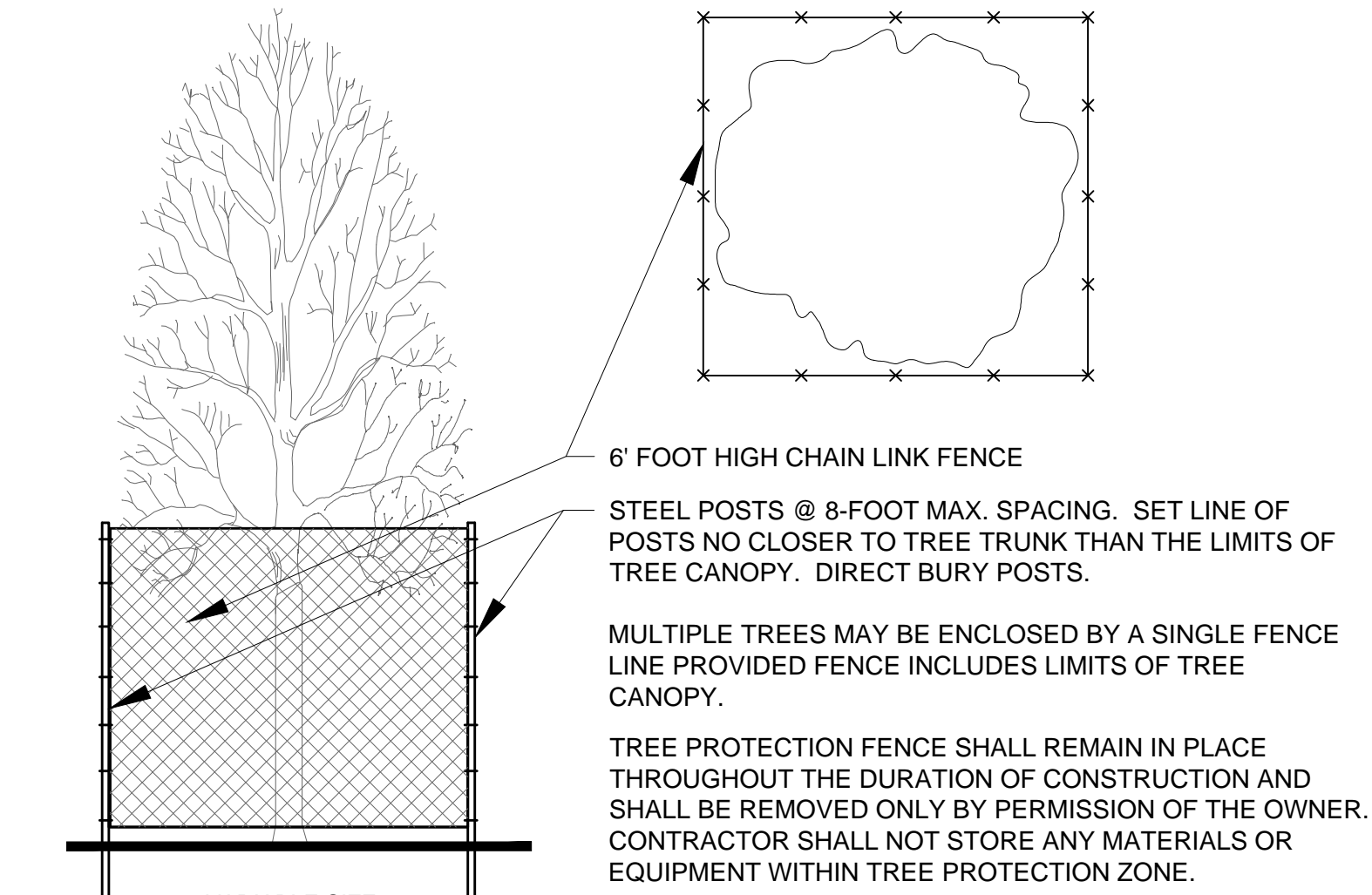
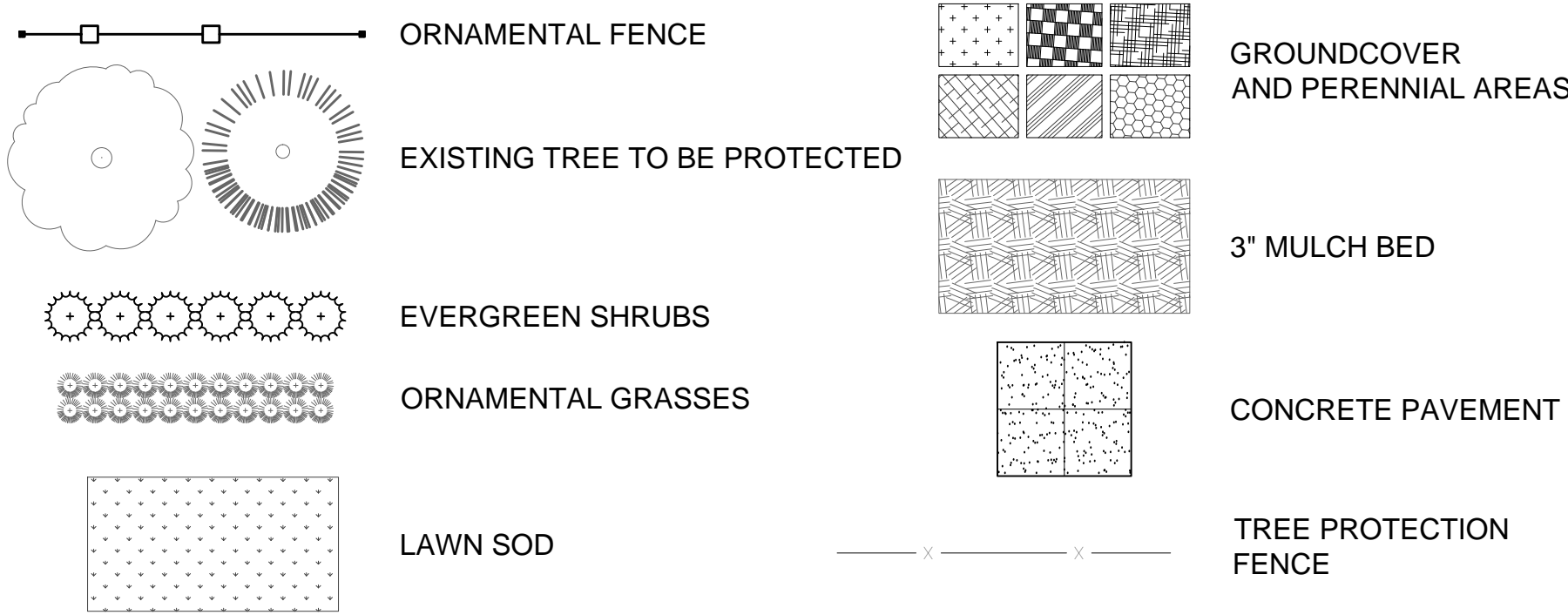

2 TREE PROTECTION DETAIL

NTS

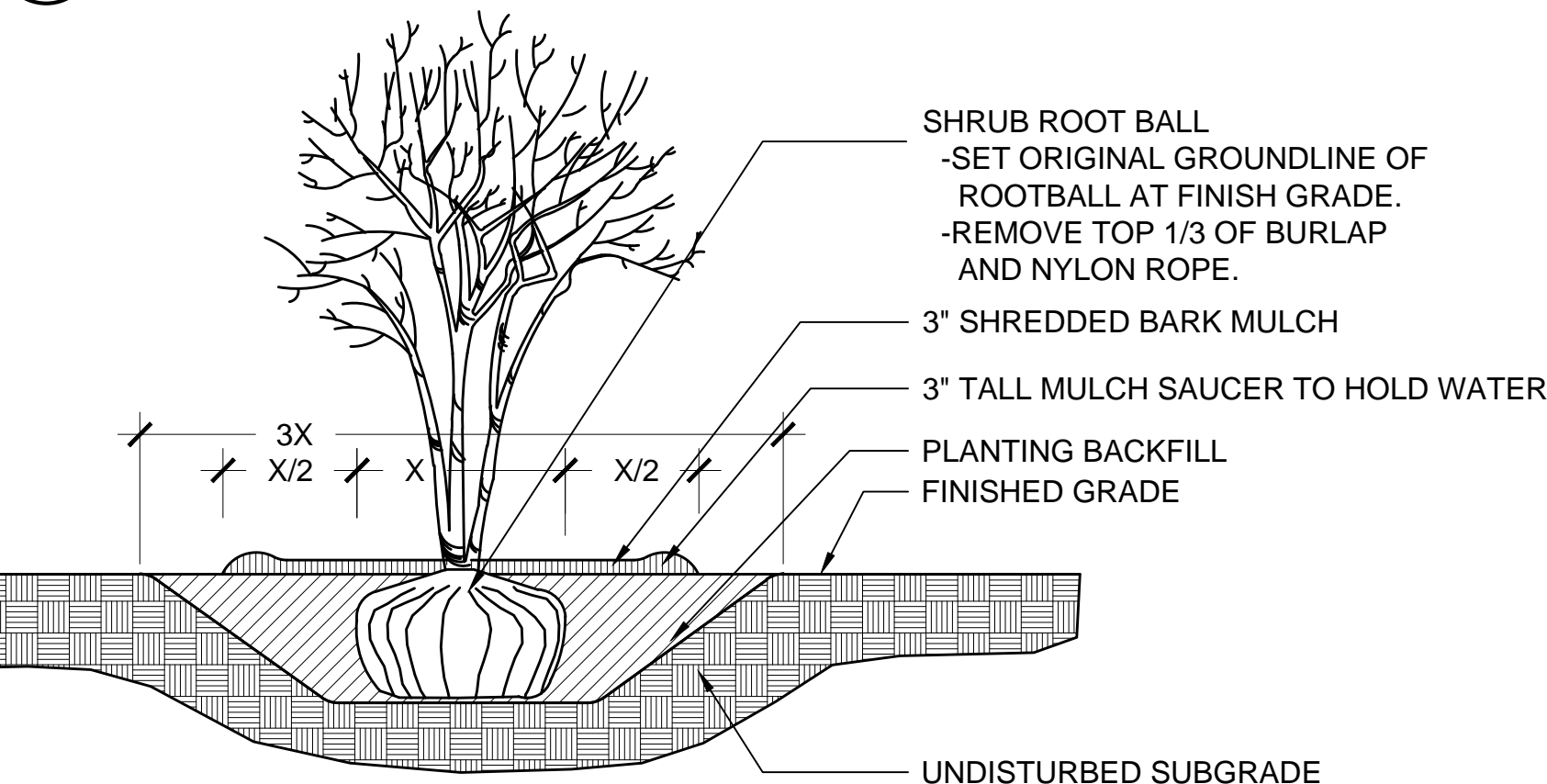

3 SHRUB AND ORN. TREE PLANTING DETAIL

NTS

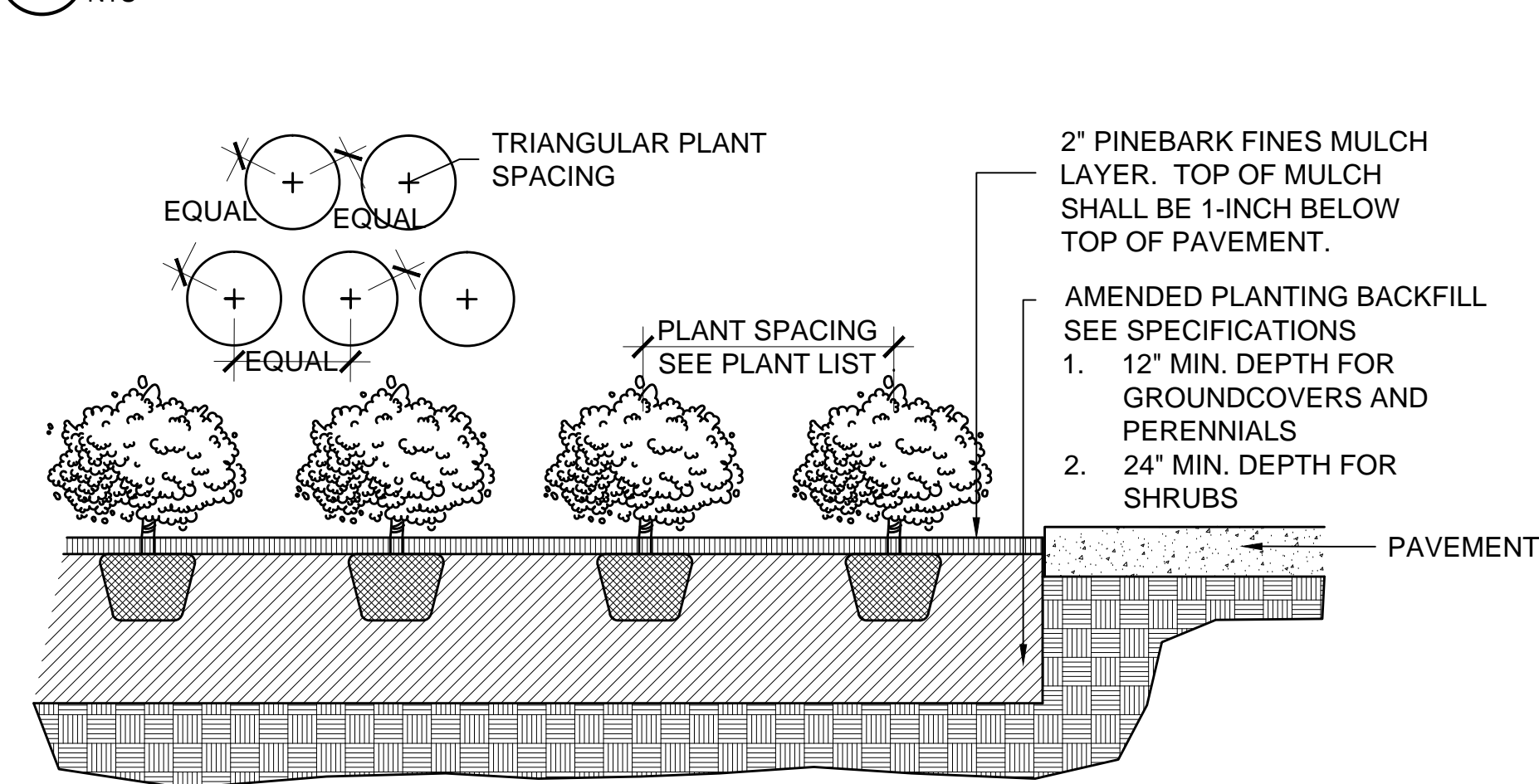

4 GROUNDCOVER / PERENNIAL PLANTING DETAIL

NTS

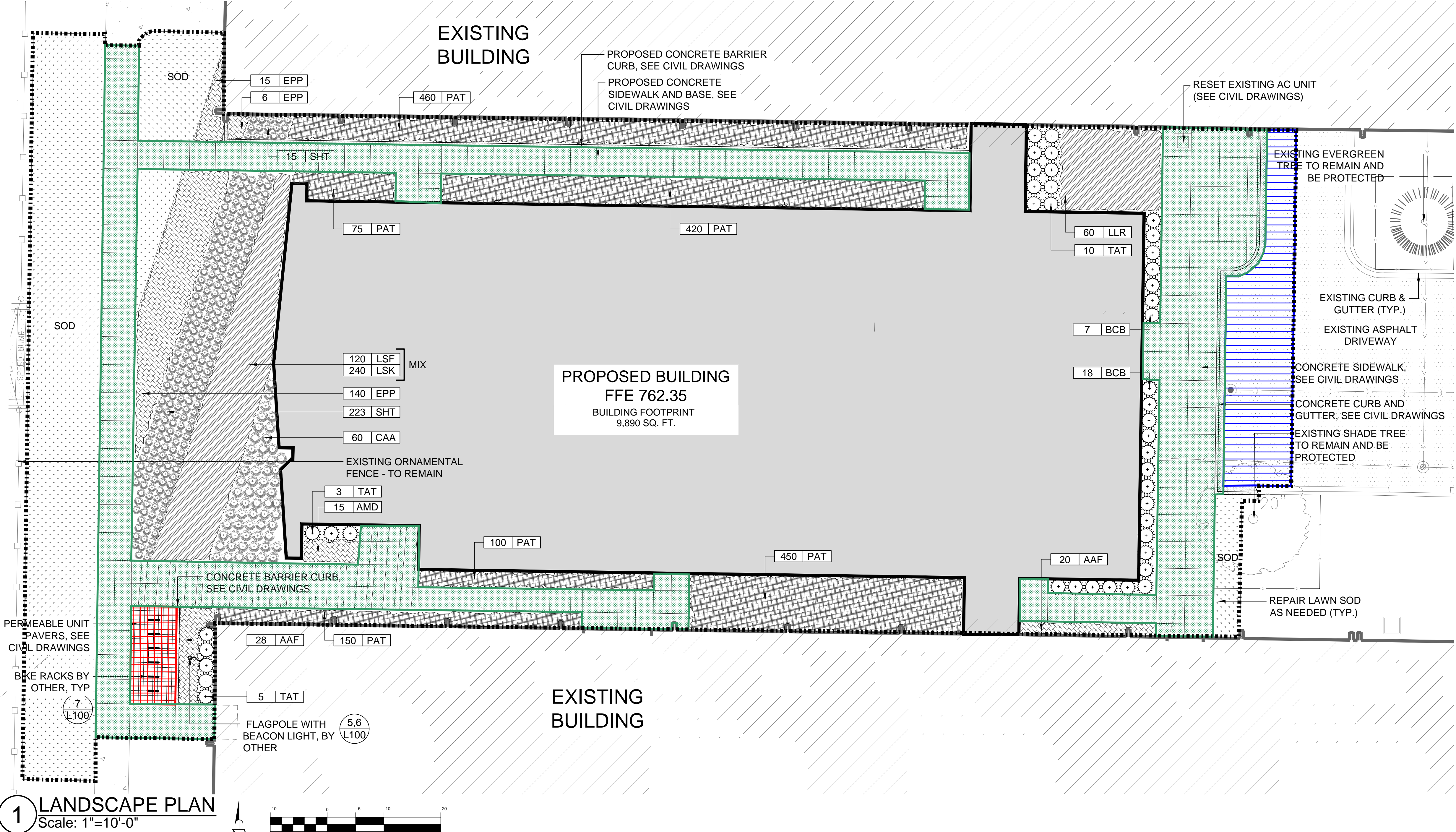

1 LANDSCAPE PLAN

Scale: 1"=10'-0"

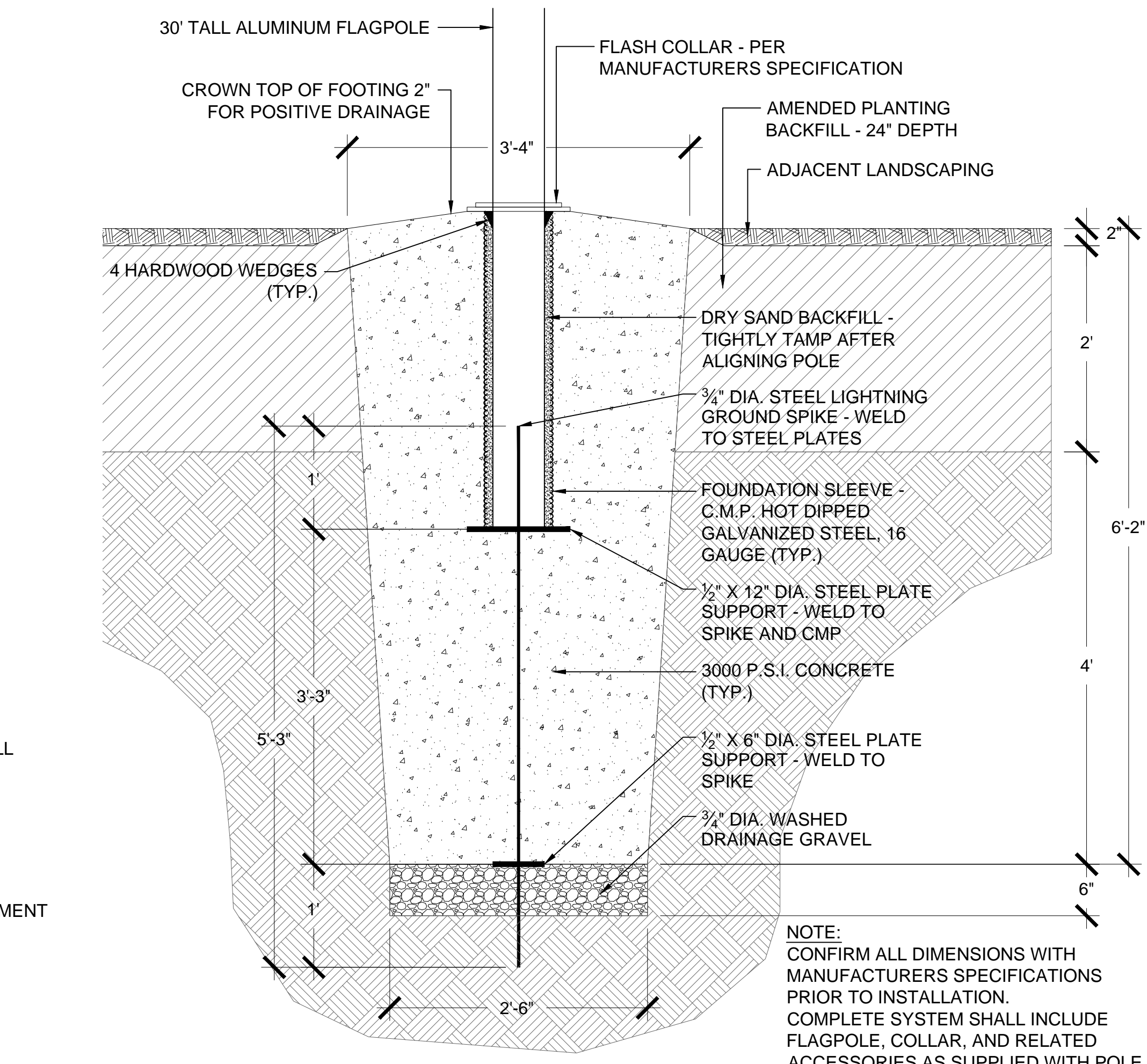
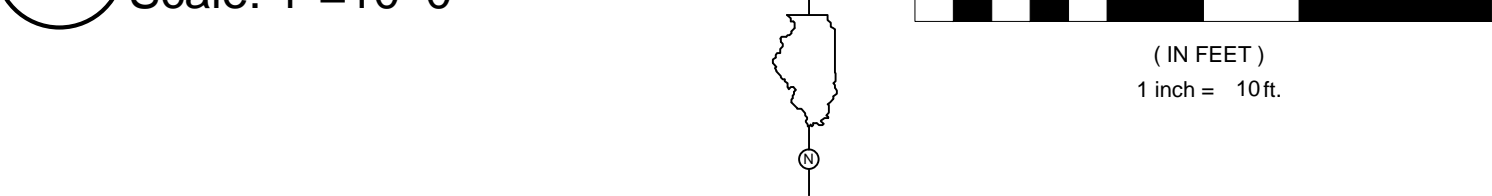

5 FLAGPOLE FOUNDATION DETAIL (BY OTHER)

SCALE: 1"=1'-0"

NOTES:
FLAG POLE BEACON
FLAG COMPANY, INC.
MODEL NUMBER: ORN-FPB-8-359-D-120V
DRIVER/BALLAST TYPE: STANDARD
LAMP TYPE: LED
VOLTAGE: 120 V
FIXTURE WATTS: 8
MOUNTING: POLE

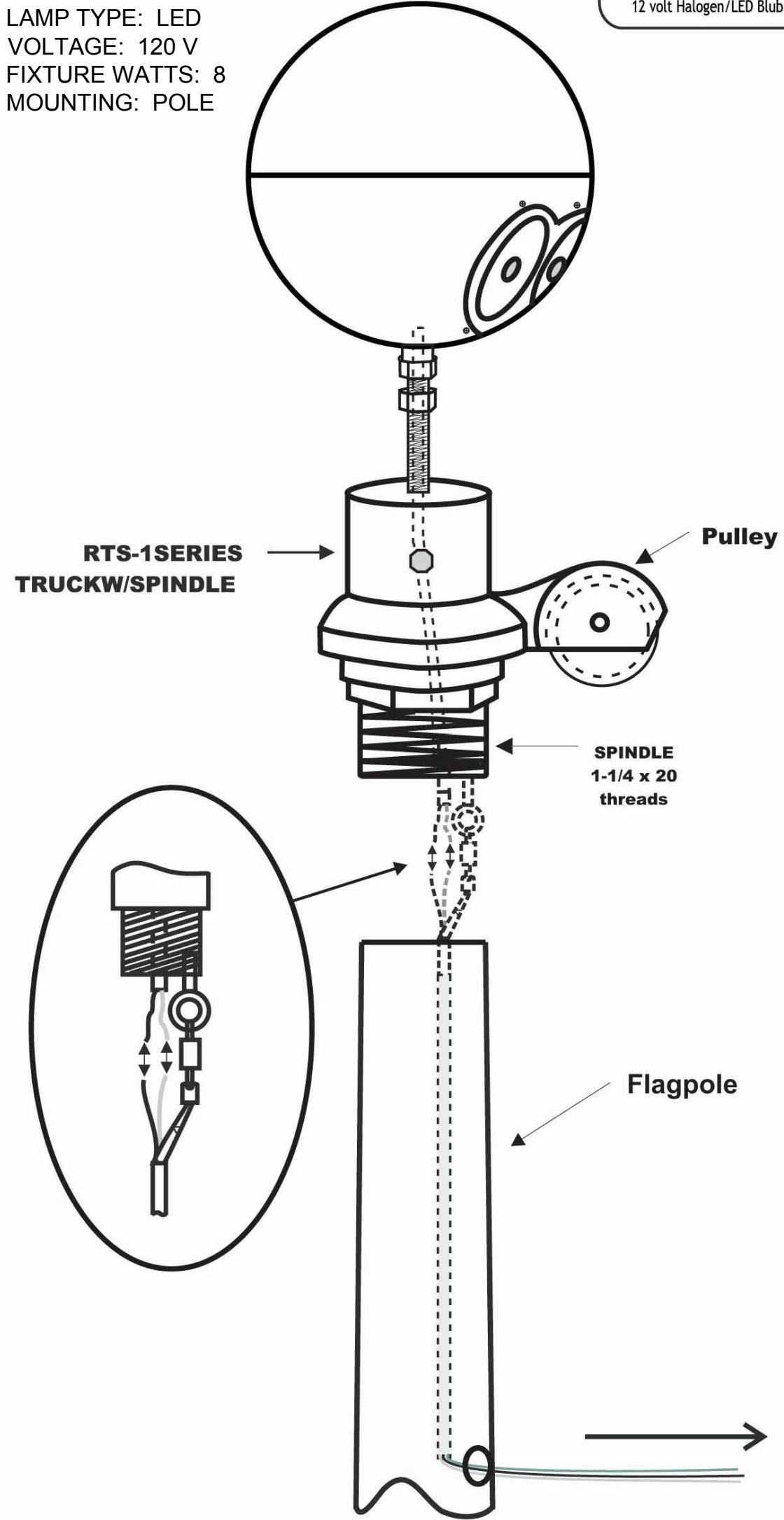

6 FLAGPOLE LIGHTING DETAIL (BY OTHER)

NTS

BICYCLE RACK NOTES:

- A. MATERIAL 1 1/2" SCHEDULE 40 (.148" WALL) BLACK IRON PIPE, O.D. = 1.90"
- B. COATING OF PART AS FOLLOWS:
- COLOR - BLACK
 - TEXTURE - REGULAR GRAIN
 - GROSS - SEMI-MATTE
 - HARDNESS, SHORE A-95 ± 3
 - TENSILE STRENGTH - 1800 PSI MIN.
 - MILDEW RESISTANT ADDITIVE
 - U.V. SCREENING ADDITIVE
 - RESISTANCE TO COLOR CHANGE
 - RESISTANCE TO ABRASION WHEN USED AS INTENDED
 - PRIMER - ENTIRE PART IS PRIMED EVEN THOUGH IT IS COMPLETELY COATED.

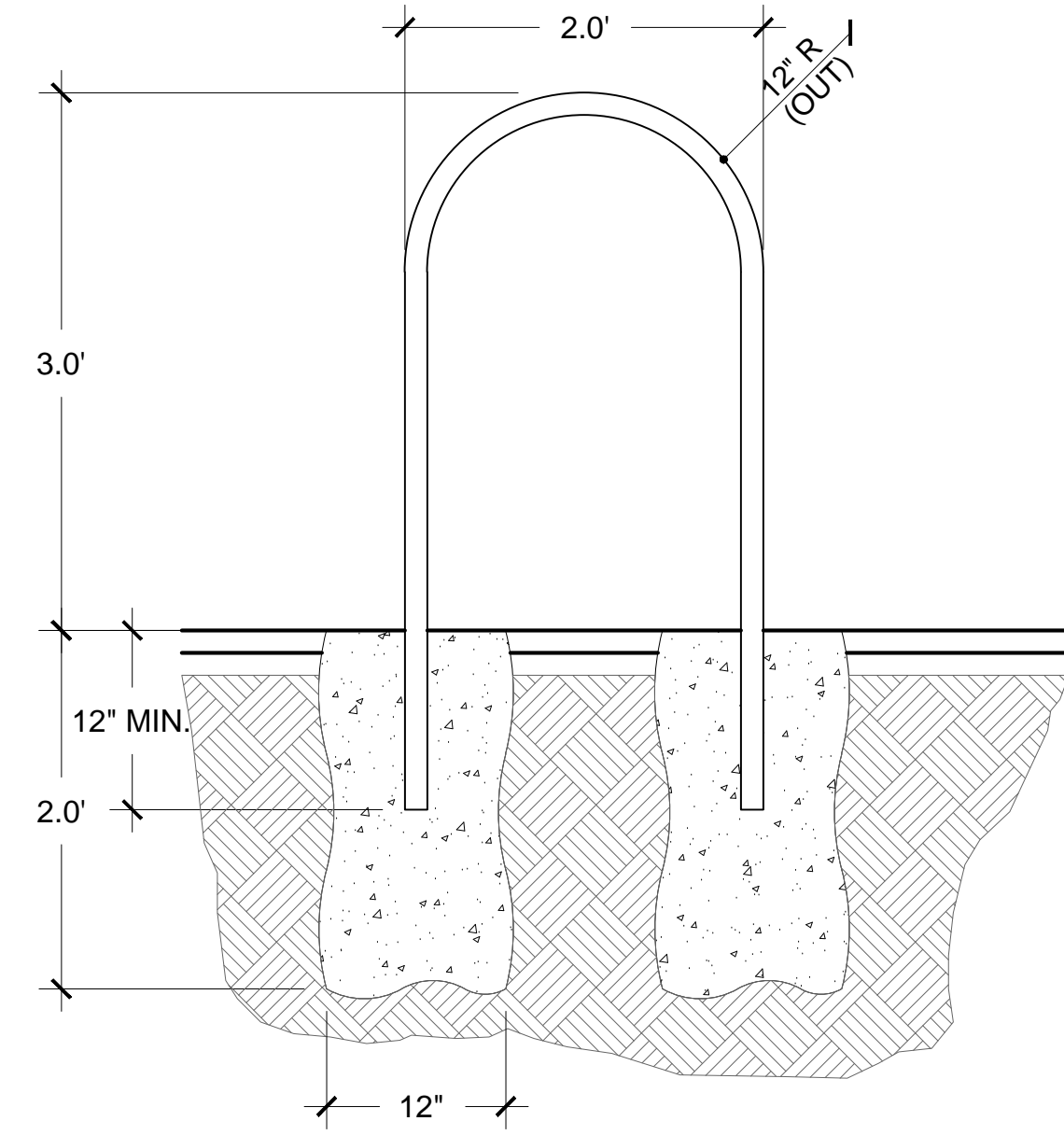

7 BICYCLE RACK DETAIL (BY OTHER)

NTS

DO

DESIGN ORGANIZATION

Planning | Architecture | Engineering | Interior Design

440 North Wells | Suite 320
Chicago, Illinois 60654 | 312.324.5500
www.designorg.com

TERRA

ENGINEERING LTD.

225 W. Ohio Street, 4th Floor
Chicago, IL 60654
TEL: (312) 467-0123
FAX: (312) 467-0220
www.terraengineering.com

NEW ASPHALT - 584 SQ. FT.

PERMEABLE PAVERS - 168 SQ. FT.

NEW CONCRETE - 3,748 SQ. FT.

LEED BOUNDARY - 21,033 SQ. FT.

SET DESCRIPTION

ISSUED FOR BID

REVISION

DATE

12.14.15

DATE

PROJECT NAME

UNIVERSITY OF ILLINOIS AT URBANA - CHAMPAIGN

CERL MAIN BUILDING ADDITION

2902 NEWMARK DR
CHAMPAIGN, IL 61822

SHEET TITLE

LANDSCAPE PLAN

SEAL

PROJECT NO.

7131230

UNIVERSITY PROJECT NO.

U13024

SHEET NO.

L100